

DO NOT SCALE DRAWING

- 1.0 PERFORMANCE
 1.1 FREQUENCY RANGE: DC-11GHz
 1.2 VOLTAGE RANGE: 1000V RMS (sea level)
 1.3 NOMINAL IMPEDANCE: 50 OHMS
 1.4 DWV: 2500V RMS @ 60Hz (sea level)
 1.5 TEMPERATURE RANGE: -65°C TO +165°C
 2.0 MATERIALS
 2.1 DIELECTRIC: PTFE

- 2.2 CENTER CONTACT: BeCu
 2.3 LOCK WASHERS: PHOS. BRONZE
 2.4 ALL OTHER METAL PARTS: BRASS
 3.0 FINISHES: SEE TABLE
 4.0 MECHANICAL
 4.1 INTERFACE IN ACCORDANCE WITH MIL-STD-348
 4.2 CENTER CONTACT MUST WITHSTAND A TORQUE OF 6 OZ. INS. AND AN AXIAL FORCE OF 15 LBS MIN. WITHOUT DISPLACEMENT

DWG NO. OL-0407-04-1		REV. A
PART NUMBER 0407-04	BODY NICKEL	CONTACT GOLD

PLATING PER SAN-TRON SPEC. 7.3.1-8

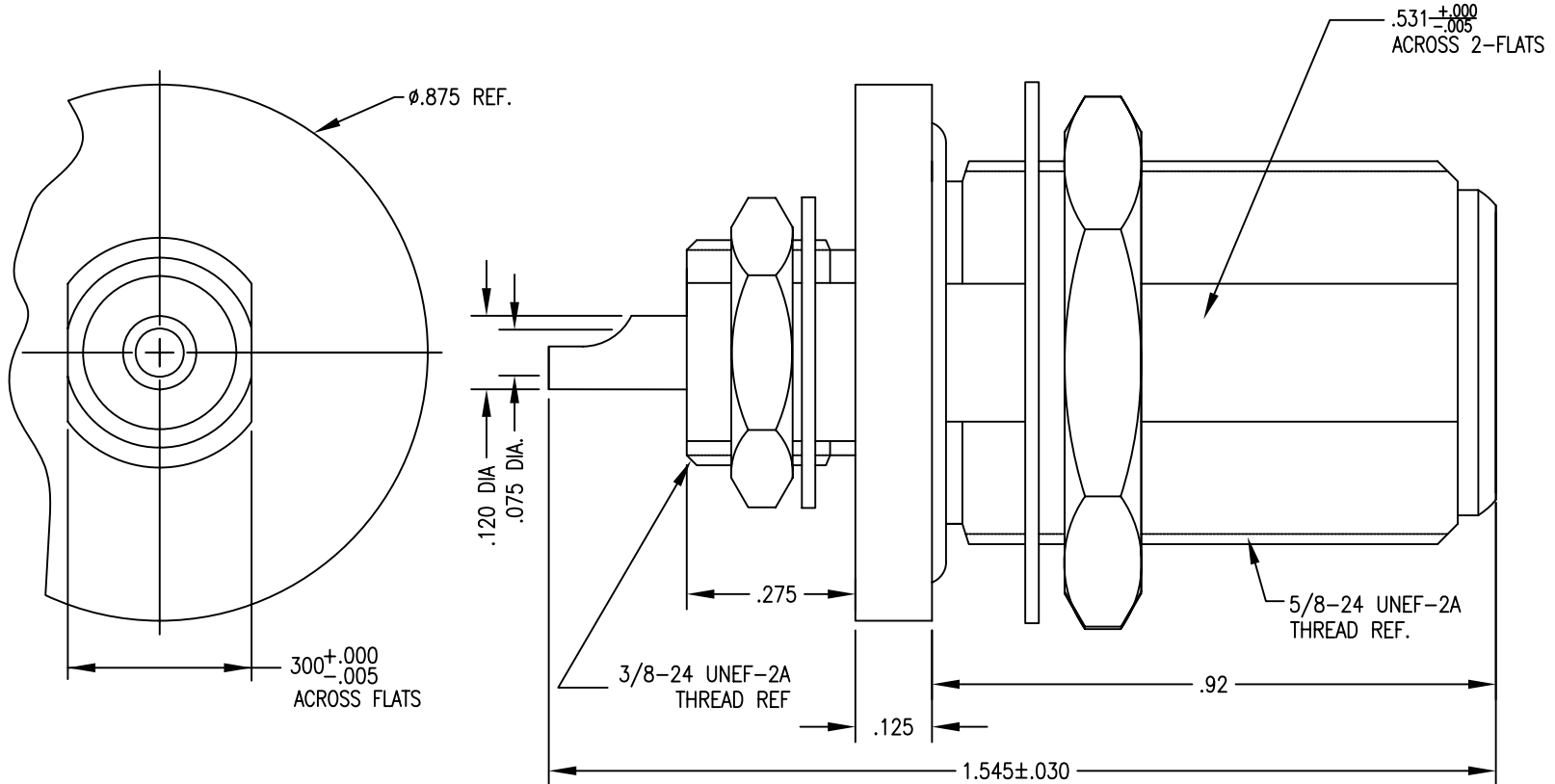

Rev.	Revisions	Disp.	Date	Dwn.	Appd.
A	OUTLINE RELEASE	NEW	2/26/09		
Ref.:	REMOVE ALL BURRS AND SHARP EDGES .005 MAX.	INTERPRET PER	ASME Y14.5M-1994		
SK-					

THIS DRAWING CONTAINS CONFIDENTIAL INFORMATION PROPRIETARY TO SAN-TRON, INC. IT MUST NOT BE REPRODUCED OR DISCLOSED TO OTHERS OR USED IN ANY OTHER WAY, IN WHOLE OR PART EXCEPT AS AUTHORIZED IN WRITING BY SAN-TRON, INC.

UNLESS OTHERWISE SPECIFIED:
 ALL DIMENSIONS ARE IN INCHES.
 ALL DIMENSIONS ARE AFTER PLATING.
 .XXX = $\pm .005$ ALL MACHINED SURFACES $64 \sqrt{\text{MAX}}$.
 .XX = $\pm .01$ ANG. $\pm 1/2'$ FRACTIONAL = $\pm 1/64$
 $\text{Ⓞ} .004$ MAX. TIR. \perp AXIS $.001$

THIRD ANGLE PROJECTION

DWN	JTH	2/26/09
CHKD	SJS	2/26/09
APPR	JTH	2/26/09

SAN-TRON, INC.
 4 NEWBURYPORT TPK. IPSWICH MA USA 01938
 TEL: 978 - 356 -1585 FAX: 978 - 356 -1573
 WWW.SANTRON.COM E MAIL: santron@santron.com

TITLE N BULKHEAD RECEPTACLE, STRAIGHT
 $\phi 3/8$ MOUNT

MATERIAL: SEE NOTES
FINISH: SEE TABLE

CAGE CODE: 50896 DWG NO. OL-0407-04-1 REV. A
 SCALE X:X